

Brass flow regulator

Series RAP - RAP BLACK - OT



The RAP flow regulator series are produced in Italy according to the reference ISO norms as warranty of high quality level.

Ordering code

B 29OT12 14 P

THRUST SLEEVE COLOUR

blank = Green
B = Black
S = Grey
A = Blue

ADJUSTING STEM

28 = For valve
29 = For cylinder
30 = Bidirectional

VERSION

OT = Nickel-plated brass thrust sleeve

TUBE CONNECTION

4 ... 12 = Tube diameter (mm)

THREADED CONNECTION

M5; 18; 14; 38; 12 = Thread size (M5; 1/8; 1/4; 3/8; 1/2)

TYPE

blank = Orientable type with screwdriver nut
P = Swivel type with adjusting knob

See assembly instructions in the appendix on page 211.

Technical sheet

FLUIDS		Compressed air (for different fluid please contact our Technical Dept.)
APPLICATIONS		Pneumatic circuits, low pressure hydraulic applications, according to DIN 3861-3870 norms.
SUGGESTED TUBES		TPU (Polyurethane), PA11/PA12 (Polyamide), TPE (Polyethylene), TPA (Polyurethane/Copolyester)
TUBES TOLERANCES		Diam. between 4 and 10 mm +/- 0,05 Diam. from 12 mm +/- 0,1
TEMPERATURE AND PRESSURE	Recommended limit values	Temperatures and pressures usually depend by the technical features of the employed tubes, anyway it is suggested a limit working pressure of 15 bar and a temperature range between -20°C and +70°C.
	Technical testing data	At page 14 there are indicated the load traction resistance values and the main working and breaking limit (Pressure and Temperature) of the main commercial tubing.
	Note	For more complete informations please read the technical catalogue of your tube supplier.
THREAD TYPE		BSP parallel UNI-ISO 228
MATERIALS	RAP body, regulation stem, "OT" sleeve	Brass UNI EN 12164 CW614N
	Sleeve, collar and back ring	POM copolymer ISO1043-1
	Spring	Stainless steel AISI 301 austenitic
	Seals	NBR 70 DWGV-EN549 UL157

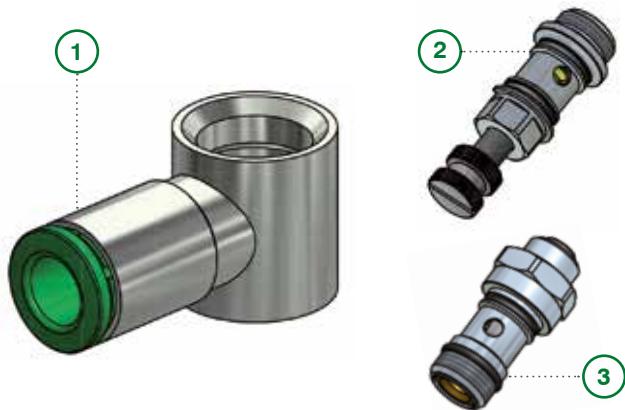

Components

- 1 Swivel banjo - "13" "13 R/*"
 - 2 Adjusting stem with knob
28A (for valve)
29A (for cylinder)
30A (bidirectional)
 - 3 Adjusting stem with screwdriver cut
28A (for valve)
29A (for cylinder)
30A (bidirectional)
- (* For M5 stem)

Additional technical informations

Flow tests

Test carried out at the Pneumax laboratory on a flow regulators sample under the following conditions:

Fluid	Filtered air
Temperature	20°C
Pression	6 bar

Tests results

N° Needle turns	Flow (ltr/min)						
	T290618	T290618P	T290614	T290614P	T290838	T290838P	T291012P
0,0	0	0	0	0	0	0	0
0,5	5	5	38	2	40	21	30
1,0	10	10	48	23	92	40	63
1,5	20	16	55	41	139	59	94
2,0	23	22	65	50	185	78	123
2,5	27	25	72	58	230	96	156
3,0	30	28	80	64	272	115	186
3,5	34	33	88	73	318	135	220
4,0	37	43	100	81	361	153	251
4,5	40	55	121	97	405	171	282
5,0	44	68	145	118	447	190	312
5,5	52	80	170	142	489	207	343
6,0	64	93	196	169	530	224	375
6,5	75	105	220	193	580	240	404
7,0	88	118	241	217	664	251	437
7,5	101	127	260	238	811	276	466
8,0	113	172	277	255	963	392	480
8,5	126	240	294	273	1075	530	485
9,0	136	283	325	300	1154	635	543
9,5	158	300	355	334	1200	700	635
10,0	191		383	364	1228	750	845
10,5	195		408	379	1235	778	1083
11,0			421	400		802	1288
11,5			427	407		814	1454
12,0			432	414		824	1588
12,5			434	417		833	1685
13,0			436	418		835	1754
13,5							1795
14,0							1820
14,5							
15,0							

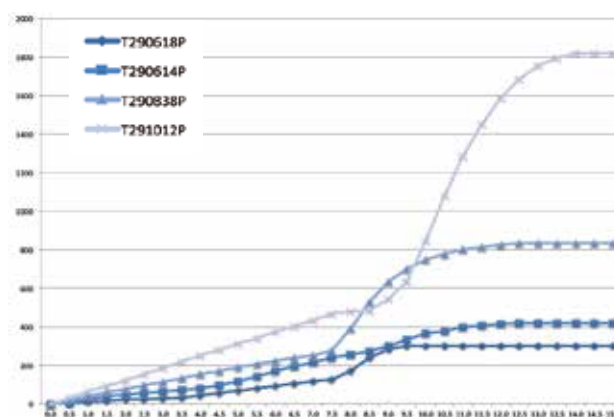
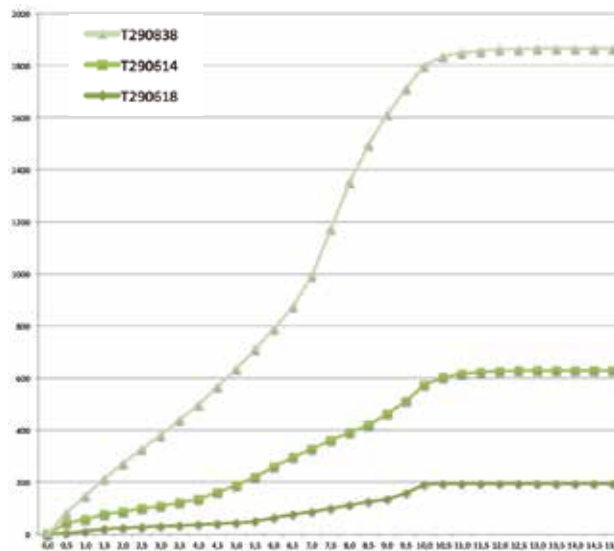



N° Needle turns	Flow (ltr/min)							
	T280618	T280618P	T280614	T280838P	T281212P	T290838-V	T290838-B	T290838-C
0,0	0	0	0	0	0	0	0	0
0,5	0	0	20	22	35	42	39	88
1,0	6	10	24	40	70	82	79	185
1,5	12	13	34	59	100	124	122	280
2,0	14	16	43	78	138	159	163	375
2,5	17	20	48	100	171	200	205	480
3,0	20	22	57	120	207	236	244	582
3,5	22	25	65	141	240	272	282	680
4,0	24	32	80	160	274	307	320	780
4,5	27	44	98	184	306	342	357	880
5,0	34	55	115	207	338	377	392	1110
5,5	44	69	142	226	370	411	425	1428
6,0	53	81	162	255	402	445	460	1628
6,5	64	94	182	360	433	478	496	1720
7,0	74	106	202	498	464	529	546	1767
7,5	84	120	221	614	494	640	642	1798
8,0	95	155	247	712	525	800	793	1820
8,5	125	207	294	778	560	970	983	1825
9,0	184	250	365	808	678	1088	1129	
9,5	185	269	442	823	877	1145	1222	
10,0		275	495	830	1079	1185		
10,5			528	835	1280	1187		
11,0			541	838	1340			
11,5			549	843	1623			
12,0			552		1760			
12,5			553		1880			
13,0					1970			
13,5					2055			
14,0					2060			
14,5								
15,0								

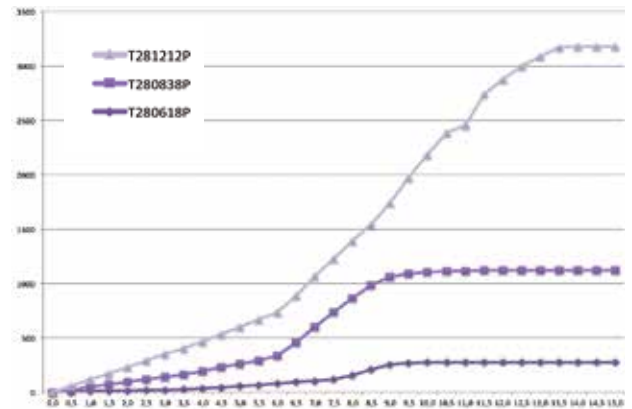
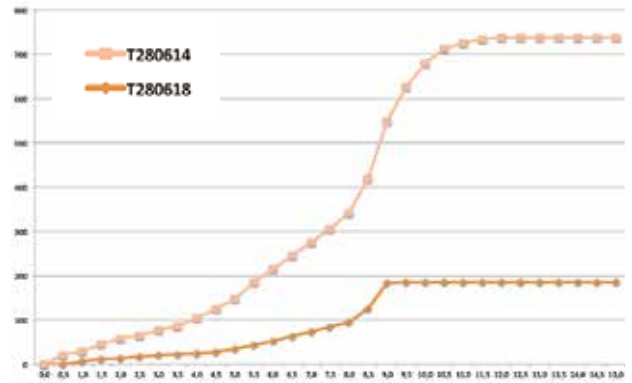

Stems G1/8" banjo diam. 4	1	2	3	4	5	m/a	um
Clamping OK	2,5	2,5	2,5	2,5		2,5	Nm
Ring crushed	3,5	3,5	3,0	3,3		3,5	Nm
Deformed ring	5,0	5,5	4,5	5,0		5,0	Nm
Stem breakage	16,4	16,4	15,3	14,5		16,0	Nm
Stems G1/4" banjo diam. 6	1	2	3	4	5	m/a	um
Clamping OK	2,5	3,0	2,5	2,5	3,0	3,0	Nm
Ring crushed	4,0	5,0	5,5	6,0	6,0	5,5	Nm
Deformed ring	7,0	7,5	8,0	8,5	9,0	8,0	Nm
Stem breakage	33,0	32,1	30,1	32,4	33,4	32,0	Nm
Stems G3/8" banjo diam. 8	1	2	3	4	5	m/a	um
Clamping OK	4,0	5,0				4,5	Nm
Ring crushed	8,0	8,5				8,0	Nm
Deformed ring	15,0	16,0				16,0	Nm
Stem breakage	41,9	44,3				43,0	Nm

Regulator code	Flow (ltr/min)	
	6 bar Δp=1 Nominal	6 bar max free exhaust
2804M5P	64	118
T280618	120	185
T280618P	170	280
T280614	320	550
T280838P	505	840
T281212P	1230	2060
T290618	120	195
T290618P	175	300
T290614	260	435
T290614P	245	420
T290838	790	1235
T290838P	525	835
T291012P	1120	1820
T300618	200	330
T301014	365	655
T290838-V	705	1185
T290838-B	775	1070
T291212-C	1160	1825



ART. **T310400**
ART. **TB310400**
In-Line Flow Regulator

Fluid	Filtered air
Temperature	20°C
Pression	5 bar

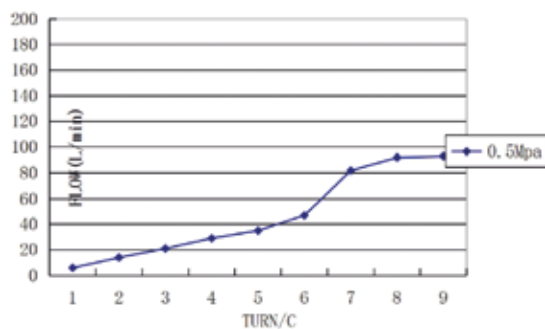

ART. **T310600**
ART. **TB310600**
In-Line Flow Regulator

Fluid	Filtered air
Temperature	20°C
Pression	5 bar

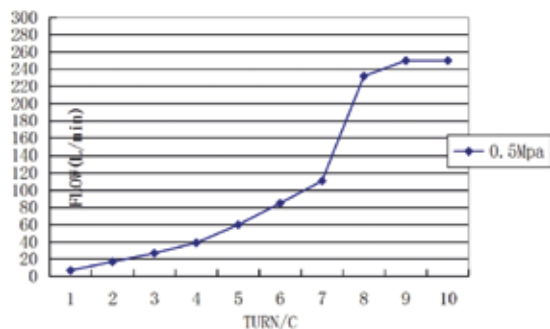

ART. **T310800**
ART. **TB310800**
In-Line Flow Regulator

Fluid	Filtered air
Temperature	20°C
Pression	5 bar

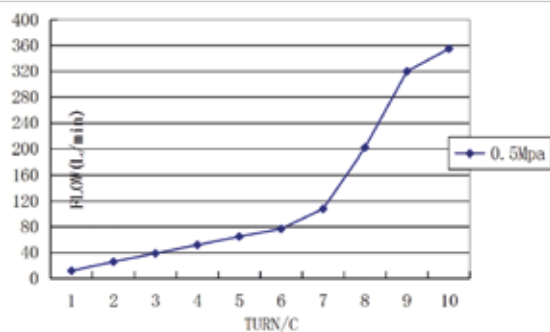

ART. **T311000**
ART. **TB311000**
In-Line Flow Regulator

Fluid	Filtered air
Temperature	20°C
Pression	5 bar

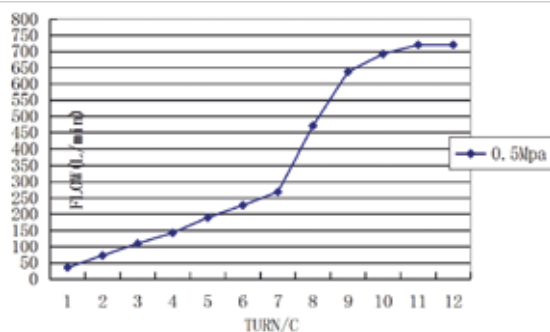

ART. **T311200**
ART. **TB311200**
In-Line Flow Regulator

Fluid	Filtered air
Temperature	20°C
Pression	6 bar

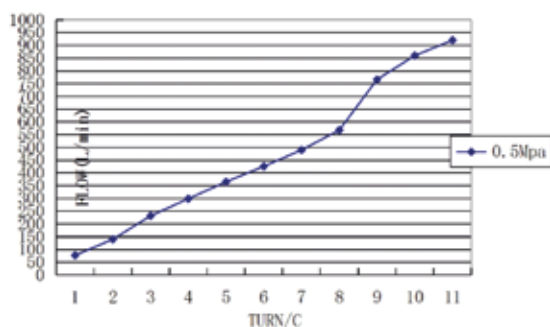

ART. **T29GS04M5**

ART. **T29GS06M5**

Speed controller for cylinders with lock cap

Fluid	Filtered air
Temperature	20°C
Pression	5 bar

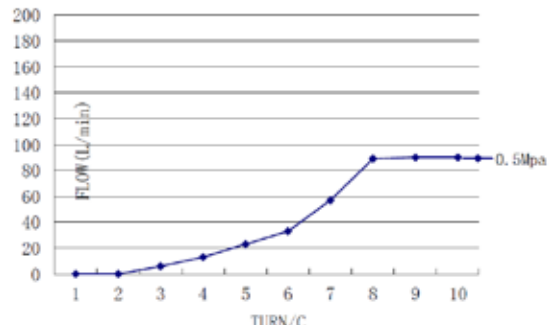

ART. **T29GS0418**

ART. **T29GS0618**

ART. **T29GS0818**

Speed controller for cylinders with lock cap

Fluid	Filtered air
Temperature	20°C
Pression	5 bar

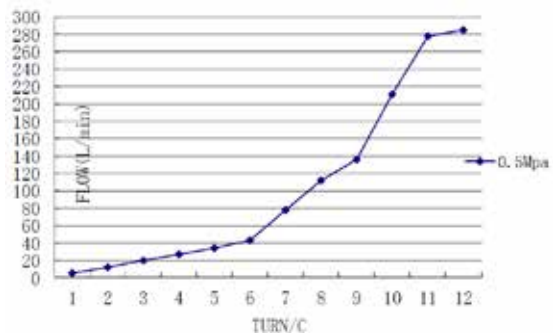

ART. **T29GS0614**

ART. **T29GS0618**

Speed controller for cylinders with lock cap

Fluid	Filtered air
Temperature	20°C
Pression	5 bar

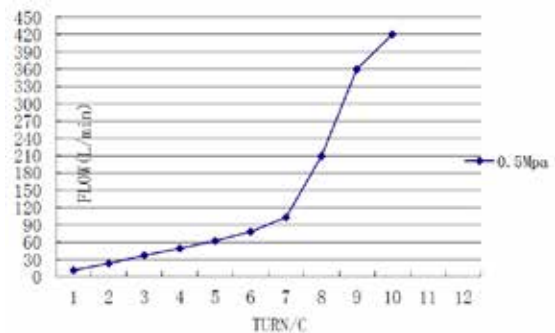

ART. **28**

Orientable flow regulator for valve



COD.	ØD	G	ØA	H	L1	L			
2804M5	4	M5	1,9	4,0	19,5	24,0	8	25	10,28
280418	4	1/8	5,5	5,5	21,1	34,0	14	25	33,86
2806M5	6	M5	1,9	4,0	21,0	24,0	8	25	11,29
280618	6	1/8	5,5	5,5	24,3	34,0	14	25	35,00
280614	6	1/4	6,0	6,5	25,5	42,0	17	25	59,68
280818	8	1/8	5,5	5,5	24,8	34,0	14	25	34,96
280814	8	1/4	6,0	6,5	26,5	42,0	17	25	60,44
280838	8	3/8	8,0	7,5	28,0	52,0	20	10	94,87
281014	10	1/4	6,0	6,5	28,4	42,0	17	25	65,86
281038	10	3/8	8,0	7,5	29,9	52,0	20	10	78,13
281238	12	3/8	8,0	7,5	31,4	52,0	20	10	99,38

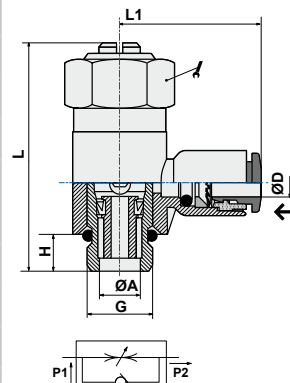

ART. **29**

Orientable flow regulator for cylinder



COD.	ØD	G	ØA	H	L1	L			
2904M5	4	M5	1,9	4,0	19,5	24,0	8	25	10,50
290418	4	1/8	5,0	5,5	21,1	34,0	14	25	33,93
2906M5	6	M5	1,9	4,0	21,0	24,0	8	25	11,29
290618	6	1/8	5,0	5,5	24,3	34,0	14	25	34,72
290614	6	1/4	6,0	6,5	25,5	42,0	17	25	60,00
290818	8	1/8	5,0	5,5	24,8	34,0	14	25	35,31
290814	8	1/4	6,0	6,5	26,5	42,0	17	25	69,97
290838	8	3/8	6,5	7,5	28,0	52,0	20	10	95,17
291014	10	1/4	6,0	6,5	28,4	42,0	17	25	65,89
291038	10	3/8	6,5	7,5	29,9	52,0	20	10	97,53
291238	12	3/8	6,5	7,5	31,4	52,0	20	10	99,65
291212	12	1/2	10,0	9	34,9	61,0	26	10	160,80

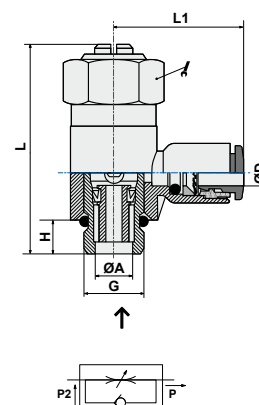

ART. **30**

Orientable bidirectional flow regulator



COD.	ØD	G	H	L1	L			
3004M5	4	M5	4,0	19,5	24	8	25	10,50
300418	4	1/8	5,5	21,1	34	14	25	33,92
3006M5	6	M5	4,0	21,0	24	8	25	11,30
300618	6	1/8	5,5	24,3	34	14	25	35,89
300614	6	1/4	6,5	25,5	42	17	25	61,44
300818	8	1/8	5,5	24,8	34	14	25	36,32
300814	8	1/4	6,5	26,5	42	17	25	62,28
300838	8	3/8	7,5	28,0	52	20	10	94,34
301014	10	1/4	6,5	28,4	42	17	25	65,89
301038	10	3/8	7,5	29,9	52	20	10	97,53
301238	12	3/8	7,5	31,4	52	20	10	99,00
301212	12	1/2	9	34,9	61	26	10	160,00

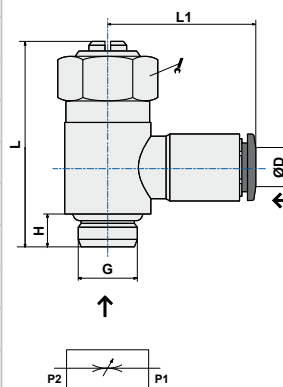

ART. **28P**

Swivel flow regulator for valve



COD.	ØD	G	H	L1	L			
2804M5P	4	M5	4	19,5	35,0	8	25	11,50
280418P	4	1/8	5,5	43,0	21,1	9	25	28,09
2806M5P	6	M5	4	21,0	35,0	8	25	12,60
280618P	6	1/8	5,5	43,0	24,3	9	25	29,09
280614P	6	1/4	6,5	50,0	25,5	12	25	51,13
280818P	8	1/8	5,5	43,0	24,8	9	25	30,08
280814P	8	1/4	6,5	50,0	26,5	12	25	51,69
281014P	10	1/4	6,5	50,0	28,4	12	25	56,18

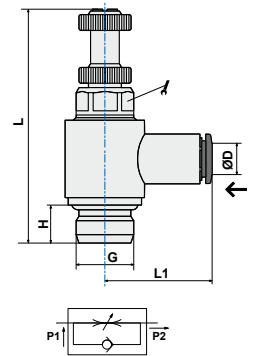

ART. **29P**

Swivel flow regulator for cylinder



COD.	ØD	G	H	L1	L			
2904M5P	4	M5	4	19,5	35,0	8	25	11,60
290418P	4	1/8	5,5	43,0	21,1	9	25	28,13
2906M5P	6	M5	4	21,0	35,0	8	25	12,60
290618P	6	1/8	5,5	43,0	24,3	9	25	29,50
290614P	6	1/4	6,5	50,0	25,5	12	25	50,55
290818P	8	1/8	5,5	43,0	24,8	9	25	29,51
290814P	8	1/4	6,5	50,0	26,5	12	25	51,43
291014P	10	1/4	6,5	50,0	28,4	12	25	56,20

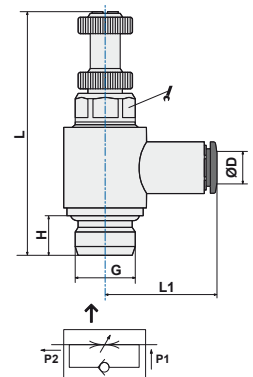

ART. **30P**

Swivel bidirectional flow regulator



COD.	ØD	G	H	L1	L			
3004M5P	4	M5	4	19,5	35,0	8	25	11,60
300418P	4	1/8	5,5	43	21,1	9	25	28,13
3006M5P	6	M5	4	21	35,0	8	25	13,00
300618P	6	1/8	5,5	43	24,3	9	25	29,50
300614P	6	1/4	6,5	50	25,5	12	25	50,55
300818P	8	1/8	5,5	43	24,8	9	25	29,51
300814P	8	1/4	6,5	50	26,5	12	25	51,43
301014P	10	1/4	6,5	50	28,4	12	25	56,20

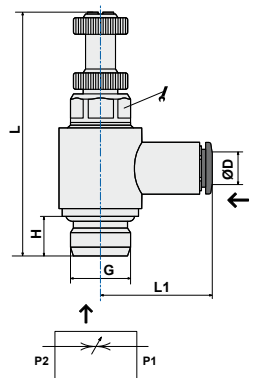

ART. **B28**

Unidirectional flow regulator for valve



COD.	ØD	G	ØA	H	L1	L			
B2804M5	4	M5	1,9	4,0	19,5	24,0	8	25	10,28
B280418	4	1/8	5,5	5,5	21,1	34,0	14	25	33,86
B2806M5	6	M5	1,9	4,0	21,0	24,0	8	25	11,29
B280618	6	1/8	5,5	5,5	24,3	34,0	14	25	35,00
B280614	6	1/4	6,0	6,5	25,5	42,0	17	25	59,68
B280818	8	1/8	5,5	5,5	24,8	34,0	14	25	34,96
B280814	8	1/4	6,0	6,5	26,5	42,0	17	25	60,44
B280838	8	3/8	8,0	7,5	28,0	52,0	20	10	94,87
B281014	10	1/4	6,0	6,5	28,4	42,0	17	25	65,86
B281038	10	3/8	8,0	7,5	29,9	52,0	20	10	78,13
B281238	12	3/8	8,0	7,5	31,4	52,0	20	10	99,38

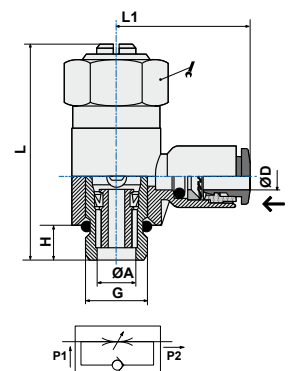

ART. **B29**

Unidirectional flow regulator for cylinder



COD.	ØD	G	ØA	H	L1	L			
B2904M5	4	M5	1,9	4,0	19,5	24,0	8	25	10,50
B290418	4	1/8	5,0	5,5	21,1	34,0	14	25	33,93
B2906M5	6	M5	1,9	4,0	21,0	24,0	8	25	11,29
B290618	6	1/8	5,0	5,5	24,3	34,0	14	25	34,72
B290614	6	1/4	6,0	6,5	25,5	42,0	17	25	60,00
B290818	8	1/8	5,0	5,5	24,8	34,0	14	25	35,31
B290814	8	1/4	6,0	6,5	26,5	42,0	17	25	69,97
B290838	8	3/8	6,5	7,5	28,0	52,0	20	10	95,17
B291014	10	1/4	6,0	6,5	28,4	42,0	17	25	65,89
B291038	10	3/8	6,5	7,5	29,9	52,0	20	10	97,53
B291238	12	3/8	6,5	7,5	31,4	52,0	20	10	99,65
B291212	12	1/2	10,0	9	34,9	61,0	26	10	160,80

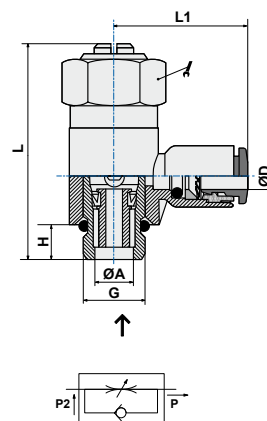

ART. **B30**

Bidirectional flow regulator



COD.	ØD	G	H	L1	L			
B3004M5	4	M5	4,0	19,5	24	8	25	10,50
B300418	4	1/8	5,5	21,1	34	14	25	33,92
B3006M5	6	M5	4,0	21,0	24	8	25	11,30
B300618	6	1/8	5,5	24,3	34	14	25	35,89
B300614	6	1/4	6,5	25,5	42	17	25	61,44
B300818	8	1/8	5,5	24,8	34	14	25	36,32
B300814	8	1/4	6,5	26,5	42	17	25	62,28
B300838	8	3/8	7,5	28,0	52	20	10	94,34
B301014	10	1/4	6,5	28,4	42	17	25	65,89
B301038	10	3/8	7,5	29,9	52	20	10	97,53
B301238	12	3/8	7,5	31,4	52	20	10	99,00
B301212	12	1/2	9	34,9	61	26	10	160,00

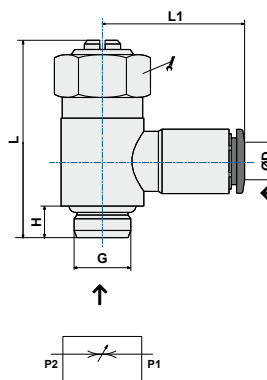

ART. **B28P**

Swivel flow regulator for valve



COD.	ØD	G	H	L	L1			
B2804M5P	4	M5	4	19,5	35,0	8	25	11,50
B280418P	4	1/8	5,5	43,0	21,1	9	25	28,09
B2806M5P	6	M5	4	21,0	35,0	8	25	12,60
B280618P	6	1/8	5,5	43,0	24,3	9	25	29,09
B280614P	6	1/4	6,5	50,0	25,5	12	25	51,13
B280818P	8	1/8	5,5	43,0	24,8	9	25	30,08
B280814P	8	1/4	6,5	50,0	26,5	12	25	51,69
B281014P	10	1/4	6,5	50,0	28,4	12	25	56,18

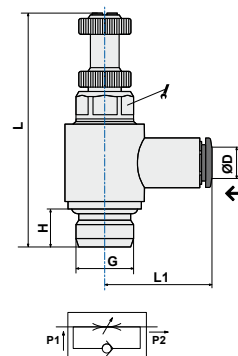

ART. **B29P**

Swivel flow regulator for cylinder



COD.	ØD	G	H	L	L1			
B2904M5P	4	M5	4	19,5	35,0	8	25	11,60
B290418P	4	1/8	5,5	43,0	21,1	9	25	28,13
B2906M5P	6	M5	4	21,0	35,0	8	25	12,60
B290618P	6	1/8	5,5	43,0	24,3	9	25	29,50
B290614P	6	1/4	6,5	50,0	25,5	12	25	50,55
B290818P	8	1/8	5,5	43,0	24,8	9	25	29,51
B290814P	8	1/4	6,5	50,0	26,5	12	25	51,43
B291014P	10	1/4	6,5	50,0	28,4	12	25	56,20

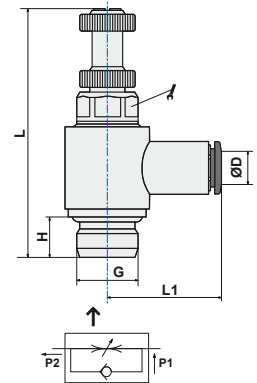

ART. **B30P**

Bidirectional flow regulator



COD.	ØD	G	H	L	L1			
B3004M5P	4	M5	4	19,5	35,0	8	25	11,60
B300418P	4	1/8	5,5	43	21,1	9	25	28,13
3006M5P	6	M5	4	21	35,0	8	25	
B300618P	6	1/8	5,5	43	24,3	9	25	29,50
B300614P	6	1/4	6,5	50	25,5	12	25	50,55
B300818P	8	1/8	5,5	43	24,8	9	25	29,51
B300814P	8	1/4	6,5	50	26,5	12	25	51,43
B301014P	10	1/4	6,5	50	28,4	12	25	56,20

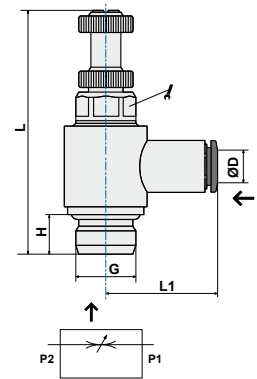

ART. **28/29/30A**

Positioned flow regulator stem



COD.	L	G	H	ØB	ØA			
28/29/30AM5*	24,0	M5	4	6,0	5,0	8	10	4,9
28/29/30A18	31,5	1/8	7	9,8	13,5	14	10	20,69
28/29/30A14	38,0	1/4	8	13,0	17,0	17	10	39,85
28/29/30A38	46,5	3/8	9	16,5	21,0	21	10	67,08
29A12 / 30A12	53,0	1/2	10	20,5	26	26	5	112,46

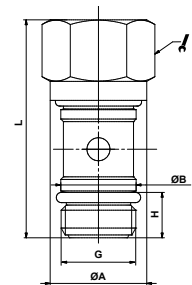

*Compatible only with versions 13R - T13R

ART. **28/29/30AP**

Swivel flow regulator stem



COD.	L max	G	H	ØB	ØA			
28/29/30AM5P*	35,0	M5	4,2	6,0	5,0	8	10	4,9
28/29/30A18P	37,5	1/8	5,9	9,8	13,5	9	10	15,00
28/29/30A14P	44,0	1/4	7,0	13,0	17,0	12	10	31,00

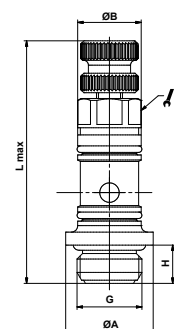

*Compatible only with versions 13R - T13R

ART. **280T**

Orientable flow regulator for valve



COD.	ØD	G	ØA	H	L1	L			
280T04M5	4	M5	1,9	4,0	19,5	24	8	25	11,48
280T0418	4	1/8	5,5	5,5	21,1	34	14	25	35,06
280T06M5	6	M5	1,9	4,0	21,0	24	8	25	36,50
280T0618	6	1/8	5,5	5,5	24,3	34	14	25	36,50
280T0614	6	1/4	6,0	6,5	25,5	42	17	25	61,18
280T0818	8	1/8	5,5	5,5	24,8	34	14	25	36,77
280T0814	8	1/4	6,0	6,5	26,5	42	17	25	62,24
280T0838	8	3/8	8,0	7,5	28,0	52	20	10	96,67
280T1014	10	1/4	6,0	6,5	28,4	42	17	25	69,86
280T1038	10	3/8	8,0	7,5	29,9	52	20	10	82,13
280T1238	12	3/8	8,0	7,5	31,4	52	20	10	103,88

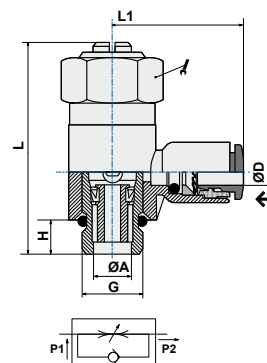

ART. **290T**

Orientable flow regulator for cylinder



COD.	ØD	G	ØA	H	L	L1			
290T04M5	4	M5	1,9	4,0	24	19,5	8	25	11,48
290T0418	4	1/8	5,0	5,5	34	21,1	14	25	35,06
290T06M5	6	M5	1,9	4,0	24	21,0	8	25	36,50
290T0618	6	1/8	5,0	5,5	34	24,3	14	25	36,50
290T0614	6	1/4	6,0	6,5	42	25,5	17	25	61,18
290T0818	8	1/8	5,0	5,5	34	24,8	14	25	36,77
290T0814	8	1/4	6,0	6,5	42	26,5	17	25	62,24
290T0838	8	3/8	6,5	7,5	52	28,0	20	10	96,67
290T1014	10	1/4	6,0	6,5	42	28,4	17	25	69,86
290T1038	10	3/8	6,5	7,5	52	29,9	20	10	82,13
290T1238	12	3/8	6,5	7,5	52	31,4	20	10	103,88
290T1212	12	1/2	10,0	9	61	34,9	26	10	165,30

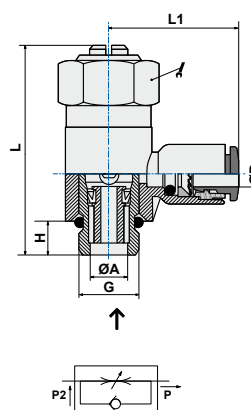

ART. **300T**

Orientable bidirectional flow regulator



COD.	ØD	G	H	L	L1			
300T04M5	4	M5	4,0	24	19,5	8	25	11,48
300T0418	4	1/8	5,5	34	21,1	14	25	35,06
300T06M5	6	M5	4,0	24	21,0	8	25	36,50
300T0618	6	1/8	5,5	34	24,3	14	25	36,50
300T0614	6	1/4	6,5	42	25,5	17	25	61,18
300T0818	8	1/8	5,5	34	24,8	14	25	36,77
300T0814	8	1/4	6,5	42	26,5	17	25	62,24
300T0838	8	3/8	7,5	52	28,0	20	10	96,67
300T1014	10	1/4	6,5	42	28,4	17	25	69,86
300T1038	10	3/8	7,5	52	29,9	20	10	82,13
300T1238	12	3/8	7,5	52	31,4	20	10	103,88
300T1212	12	1/2	9	61	34,9	26	10	165,30

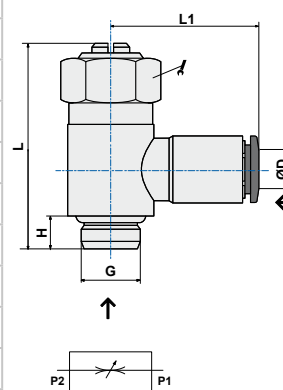

ART. **280T-P**

Swivel flow regulator for valve



COD.	ØD	G	H	L	L1			
280T04M5P	4	M5	4	19,5	35,0	8	25	12,70
280T0418P	4	1/8	5,5	43,0	21,1	9	25	29,29
280T06M5P	6	M5	4	21,0	35,0	8	25	13,80
280T0618P	6	1/8	5,5	43,0	24,3	9	25	30,59
280T0614P	6	1/4	6,5	50,0	25,5	12	25	52,63
280T0818P	8	1/8	5,5	43,0	24,8	9	25	31,88
280T0814P	8	1/4	6,5	50,0	26,5	12	25	53,49
280T1014P	10	1/4	6,5	50,0	28,4	12	25	60,18

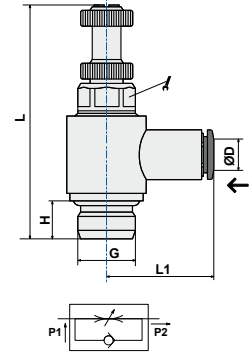

ART. **290T-P**

Swivel flow regulator for cylinder



COD.	ØD	G	H	L	L1			
290T04M5P	4	M5	4	19,5	35,0	8	25	12,70
290T0418P	4	1/8	5,5	43,0	21,1	9	25	29,29
290T06M5P	6	M5	4	21,0	35,0	8	25	13,80
290T0618P	6	1/8	5,5	43,0	24,3	9	25	30,59
290T0614P	6	1/4	6,5	50,0	25,5	12	25	52,63
290T0818P	8	1/8	5,5	43,0	24,8	9	25	31,88
290T0814P	8	1/4	6,5	50,0	26,5	12	25	53,49
290T1014P	10	1/4	6,5	50,0	28,4	12	25	60,18

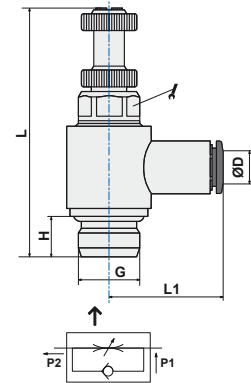

ART. **300T-P**

Swivel bidirectional flow regulator



COD.	ØD	G	H	L	L1			
300T04M5P	4	M5	4	19,5	35,0	8	25	12,70
300T0418P	4	1/8	5,5	43	21,1	9	25	29,29
300T06M5P	6	M5	4	21	35,0	8	25	13,80
300T0618P	6	1/8	5,5	43	24,3	9	25	30,59
300T0614P	6	1/4	6,5	50	25,5	12	25	52,63
300T0818P	8	1/8	5,5	43	24,8	9	25	31,88
300T0814P	8	1/4	6,5	50	26,5	12	25	53,49
300T1014P	10	1/4	6,5	50	28,4	12	25	60,18

